

OT OPEN TO **everyone**

A new £4m capital development project
to transform Richmond-upon-Thames



OT ORANGE
TREE
THEATRE
A powerhouse of independent theatre



Welcome to the Orange Tree Theatre

The Orange Tree Theatre is a local theatre with a global reputation, sitting in the heart of Richmond-upon-Thames.

We're an intimate theatre with the audience wrapped around the stage. A show at the Orange Tree is close-up magic: live, entertaining, unmissable.

We punch above our weight to create world-class productions of new and contemporary drama, revitalise classics and re-discoveries, and we are deeply rooted in our local community. We introduce children and young people to the magic of theatre and work with thousands of people aged 0 to 100 in Richmond and beyond.

We are thrilled to announce a project to evolve our building into a more inclusive, 'Theatre for Everyone'. Planned for 2026, our £4m capital development project is designed with our community at its heart. We won't touch our beautiful auditorium but will adapt our front and back of house areas to transform accessibility, create a welcoming space, invest in our community and embed sustainability.

We hope you'll help keep the OT's ethos alive for the next generation of theatregoers and that we'll see you at the OT soon.

Tom Littler
Artistic Director

Hanna Streeter
Executive Director



“The punchy Orange Tree proves itself once more to be one of the most risk-taking theatres in the capital”

Evening Standard

Artist impression of the new building



Our History and Achievements



In 1971 the Orange Tree Theatre began its journey in a small room above the pub in Richmond. We built a community and staged lunchtime shows lit by daylight, a simple circle of chairs creating a space in the round.

In 1991 we moved into our iconic and intimate theatre-in the round designed by architect Iain Mackintosh. A show at the Orange Tree is close-up magic, with the audience wrapped around the stage.

We have treasured every visitor, supporter, and performance that has shaped our beloved community.

Today, the OT has become one of the UK's top theatres, internationally renowned for giving forgotten classics a new life, as well as premiering captivating new works.



“Another example of the Orange Tree punching above its weight”

The Telegraph

In 2023/24 we curated and produced our most successful year in recent history, in which we...

- Produced the **three bestselling shows** and the highest grossing new play in the OT's history.
- Were nominated for our first ever **Olivier Award** and we have since been nominated for the **Stage Theatre of the Year 2025**.
- Won an **Evening Standard Award** and the **Critics' Circle Empty Space Award** for the most innovative small theatre in the UK.
- Increased box office sales by **75%** on the previous year with **55,000** people seeing an OT show.

With this exciting momentum, now is the time to evolve our spaces and create a 'theatre for everyone'.

Finn Cole Red Speedo by Lucas Hnath photo © Johan Persson

The project

Partnering with renowned architects Allies and Morrison we have planning permission for this revolutionary design which will **transform our accessibility, create a welcoming space, invest in our local community and embed sustainability.**

The project will focus on enhancing the visitor experience both front of house and backstage, while ensuring our iconic theatre auditorium remains unchanged – preserving the warmth and intimacy that has defined the OT.

Construction is planned for 2026, and we will continue to produce work in the theatre throughout this time.



Artist impression of the new foyer

The project

Following an audience consultation in 2022, issues were raised around accessibility, cramped space, and lack of toilet facilities in our historic building. Working with renowned architects Allies and Morrison, a new and revolutionary design will create a theatre that is truly **Open to Everyone**.

These major improvements include:

- 1 2 Single level access for wheelchairs, buggies and all visitors
 - 3 A new staircase and lift making all levels of the theatre accessible to all.
 - 4 Double the foyer space, split over two levels, opening up the front of house during shows and offering a space for the whole community to use during the daytime.
 - 5 New balcony providing level access into the Attenborough Room
 - 6 Refitted dressing rooms to create accessible backstage facilities, allowing actors with disabilities to perform on stage for the first time.
 - 7 More toilets. An additional female toilet, an additional accessible toilet, and an additional gender neutral toilet.
 - 8 6 wheelchair viewing positions at stage level. Three times the existing provision
- 22% reduction in annual carbon emissions for the building

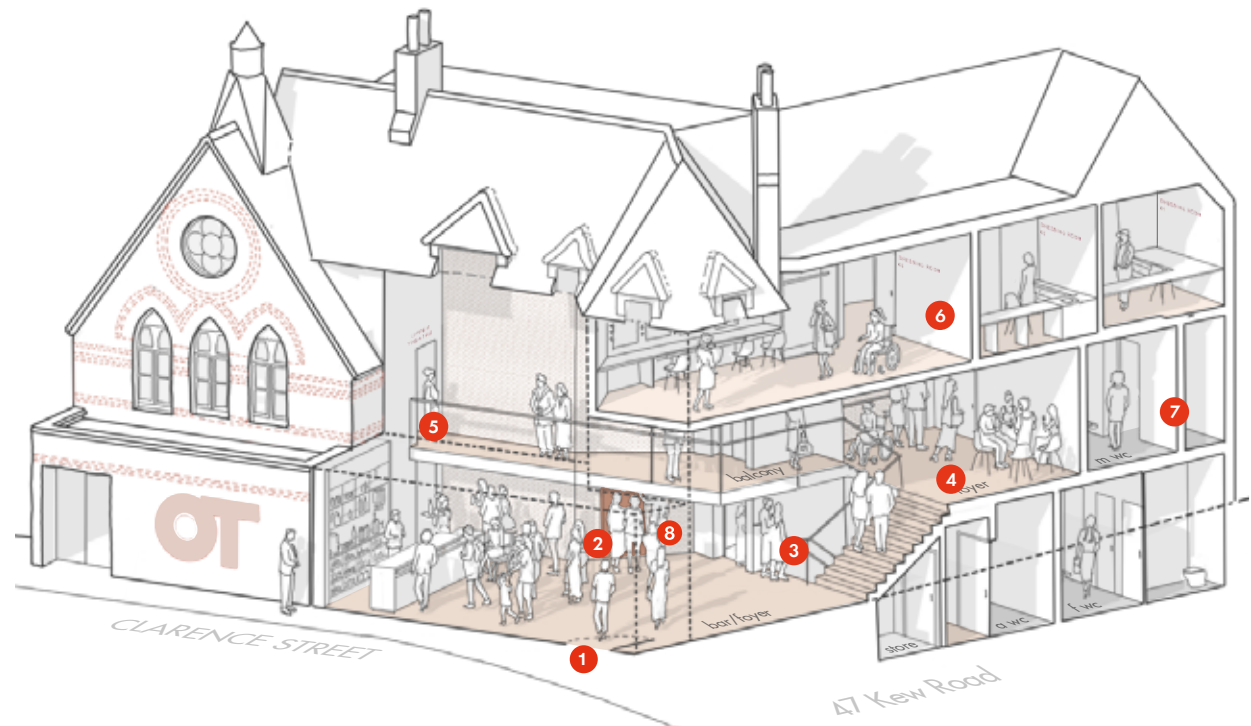

The impact

We will:

Transform access

With no steps, a new lift and full wheelchair access, everyone can enter through the same front door.

Create a welcoming space

Improving facilities with additional toilets, more space for audiences, community

Invest in our local community

Protecting the cultural heritage of Richmond and positively impacting our local economy.

Embed sustainability

Reducing our carbon footprint and heating costs.



“The Orange Tree Theatre has always held a special place in my heart, having been one of the founding company members when it started above the pub. The theatre’s charm lies in its unique intimacy and the connection it fosters between audience and actors.

This front-of-house redevelopment project will preserve that essence while making the OT accessible to everyone in our community, both onstage and off. I’m thrilled to see the theatre take this step towards a future where even more people can share in its warmth and creativity.”

Oliver Ford Davies, OBE



Investing in Richmond and beyond

We will align with the London Borough of Richmond upon Thames' (LBRuT) new cultural strategy for 2021 – 2031. Their vision is that Richmond will have an ambitious, innovative and sustainable cultural offer with more opportunities for more people, fostering lifelong access to culture for all.

We will:

- Create a more vibrant cultural quarter at the Kew Road end of Richmond
- Activate Clarence Street and create a more visual aesthetic when turning right out of Richmond Station
- Better support other local businesses
- Be a catalyst for further development at the Kew Road end of Richmond. A long term ambition is that LBRuT will pedestrianise part of Clarence Street to create a more vibrant street surrounded by thriving local businesses, bars, cafes and restaurants, and a place for weekend market stalls feeding Richmond's town centre economy.



Artist's impression of the future of Clarence Street

To achieve this £4m project and leave a lasting legacy on the cultural life of Richmond-upon-Thames, we need your support.

Join us on the journey now.

We invite you to support us at this exciting stage and play a leading role in the future of the Orange Tree Theatre.

	Your gift	Total cost to you <i>(if higher rate taxpayer)</i>	Our thanks
Founder's Circle	£100,000+	£75,000	Accreditation on our new mezzanine floor; an invitation to our Founder's Dinner <i>plus:</i>
Orchard	£50,000+	£37,500	Accreditation on our campaign supporters board which will be placed for at least 10 years in the new mezzanine.
Grove	£20,000+	£15,000	
Canopy	£10,000+	£7,500	Hard hat tour
Roots	£5,000 +	£3,750	

OT **OPEN TO** everyone

Thank you for your interest in supporting this major development project.

We warmly invite you to engage in a discussion about making a donation and there are a number of ways you can do so:

- 1 Make a thoughtful and proportionate personal or family financial pledge.
- 2 Introduce the OT to other individuals and families.
- 3 Host a fundraising briefing and cultivation event of your own.
- 4 Introduce the OT to grant-making trusts and foundations.
- 5 Create opportunities with corporate partners and sponsors.

To discuss further, please contact
Hanna Streeter, Executive Director & Joint CEO
hanna.streeter@orangetreetheatre.co.uk
020 8940 0141 ext 208



To discuss further, please contact **HANNA STREETER** Executive Director & Joint CEO
hanna.streeter@orangetreetheatre.co.uk // 020 8940 0141 ext 208

